

Belt Size 10 mm × 330 mm			
Grit	PN		
	Zirconia(Z)	Aluminum Oxide(AA)	Ceramic(CE)
#40	—	—	TB08368
#60	TA9A064	—	TB08369
#80	TB00076	—	TB08370
#100	TB00077	—	TB08371
#120	TB00247	—	TB08372
#180	TB00248	—	—
#240	TB00249	—	—
#400	—	TA9A244	—
	50 pcs./set		50 pcs./set

Belt Size 20 mm × 520 mm			
Grit	PN		
	Zirconia(Z)	Aluminum Oxide(AA)	Ceramic(CE)
#40	TA99605	—	TB08373
#60	TA99606	—	TB08374
#80	TA99607	—	TB08375
#100	TA99608	—	TB08376
#120	TA99609	—	TB08377
#180	TB00250	—	—
#240	TB00251	—	—
#280	—	TA9A252	—
#320	—	TA9A253	—
#400	—	TA9A254	—
	20 pcs./set		20 pcs./set

Belt Size 30 mm × 540 mm			
Grit	PN		
	Zirconia(Z)	Aluminum Oxide(AA)	Ceramic(CE)
#40	TB00252	—	TB08378
#60	TB00253	—	TB08379
#80	TB00254	—	TB08380
#100	TB00255	—	TB08381
#120	TB00256	—	TB08382
#180	TB00257	—	—
#240	TB00258	—	—
#280	—	TA9A262	—
#320	—	TA9A263	—
#400	—	TA9A264	—
	20 pcs./set		20 pcs./set

Focused on you
NITTO KOHKI CO., LTD.
 Web www.nitto-kohki.co.jp/e

DISTRIBUTED BY

Dimensions (mm)

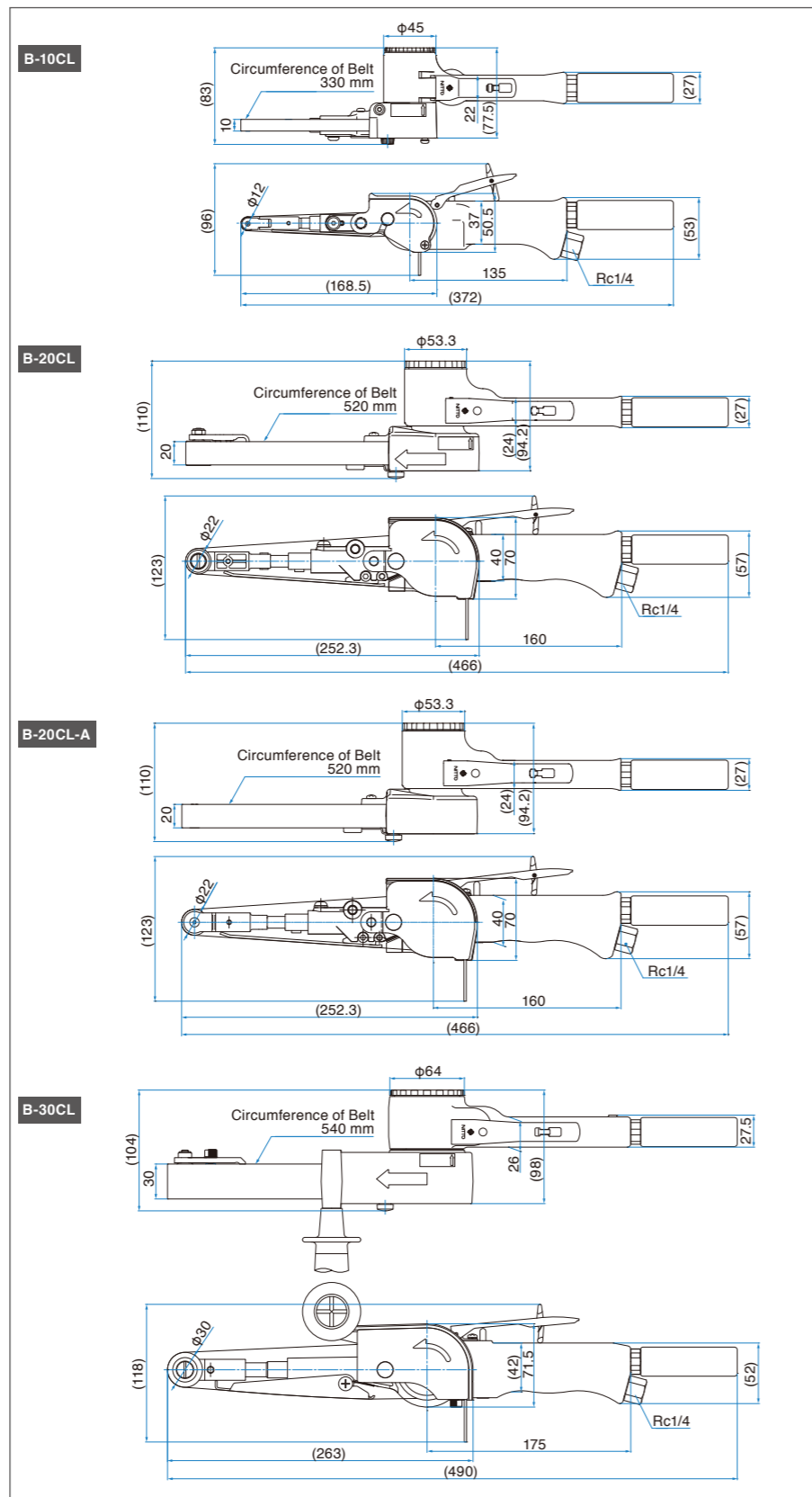

Head Office
 9-4, Nakaikogami 2-chome, Ohta-ku, Tokyo 146-8555, Japan
 Tel : +81-3-3755-1111 Fax : +81-3-3753-8791
 E-mail : overseas@nitto-kohki.co.jp



Pneumatic Belt Sander

BELTON CL Type Model B-10CL/B-20CL/B-20CL-A/B-30CL

*The new motor lasts
 2.5 times longer!
 (compared to current product)*



The best-selling BELTON is reborn with more POWER !!

BELTON
- CL TYPE -

- ◇ Outer appearance updated with a high-end looking body surface finished by buffing.
- ◇ Increased motor lifetime by adopting advanced material motor vanes.



B-20CL

Adjustable angle for efficient operation

Guard angle can be changed in accordance with the working position and shape of the workpiece.

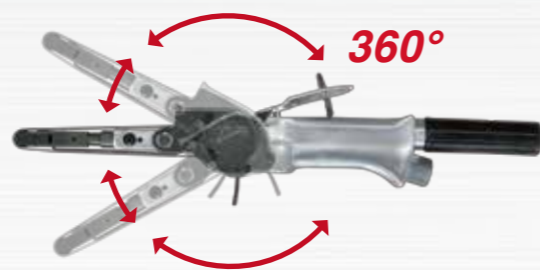

Belt Speed Adjustment

Belt speed can be easily adjusted by turning the adjust valve with a screwdriver.

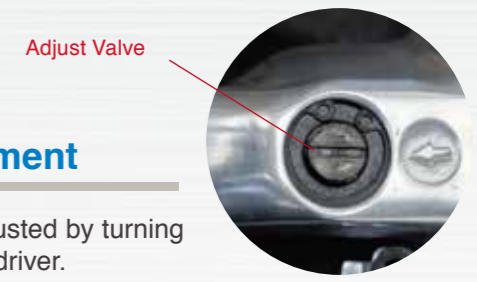

Features



The Idle Pulley for B-20CL is supported on one side only.

NEW
B-20CL-A

Curved surface grinding

Curved surface grinding is possible by using the Offset Bracket (Optional).

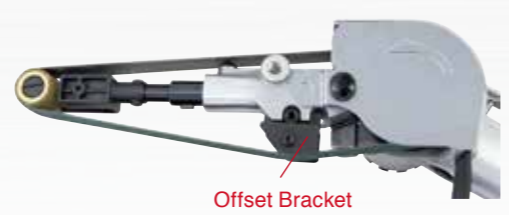

Easy belt change

Abrasive belt can be changed easily.
*Rotate and open the cover when changing.

Self-locking

For all models

Push the idle pulley into self-lock position to loosen the belt.

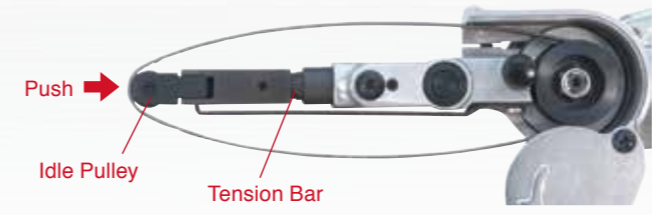

10/20 Type

Press the push button to pull back the tension bar.

Unlock

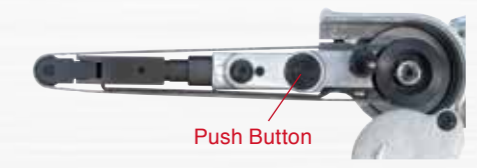

30 Type

Press the shoe in the direction of the arrow.

Unlock

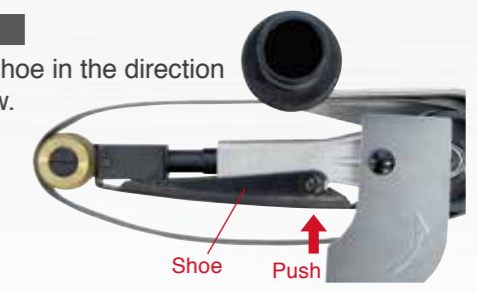

Specifications

Model	B-10CL	B-20CL	B-20CL-A	B-30CL
Air Pressure MPa(kg/cm ²)	0.6(6)	0.6(6)		0.6(6)
Air Consumption(No-load) m ³ /min	0.4	0.48		0.82
Free Speed min ⁻¹	17000	18000		15000
Belt Speed m/min	1120	2770		2310
Belt Size mm	10x330	20x520		30x540
Mass (Weight) kg	0.9	1.6	1.5	2.4
Vibration Level (according to ISO20463)* m/s ²	1.21	1.32	1.09	at Grip:0.56 at Handle:1.88
Accessories Included	<ul style="list-style-type: none"> · Abrasive Belt Z #60x10 mm : 2 pieces (1 piece installed) · Abrasive Belt #80x10 mm : 1 piece · #100x10 mm : 1 piece · #120x10 mm : 1 piece · Hex. Socket Screw Key 1.5 mm, 4 mm : 1 piece 	<ul style="list-style-type: none"> · Abrasive Belt Z #60x20 mm : 2 pieces (1 piece installed) · Abrasive Belt #80x20 mm : 1 piece · #100x20 mm : 1 piece · #120x20 mm : 1 piece · Hex. Socket Screw Key 2.5 mm, 4 mm : 1 piece · Convex Shoe : 1 piece · Silencer Sub Ass'y : 1 set 	<ul style="list-style-type: none"> · Abrasive Belt Z #60x30 mm : 2 pieces (1 piece installed) · Abrasive Belt #80x30 mm : 1 piece · #100x30 mm : 1 piece · #120x30 mm : 1 piece · Hex. Socket Screw Key 5 mm : 1 piece · Handle Ass'y : 1 set · Silencer Sub Ass'y : 1 set 	

* Figures may vary depending on applications.

Optional Parts

No.	PN	Description	Sales Unit	B-10CL	B-20CL	B-20CL-A	B-30CL
①	TB09997	Offset Bracket 10 Ass'y	1 set	●			
②	TB10192	Offset Bracket 20 Ass'y	1 set		●	●	
③	TB08150	Offset Bracket 30 Ass'y	1 set				●
④	TB09938	Finger Pad Ass'y	1 set		●	●	
⑤	TB09996	Bracket 6 Ass'y	1 set	●			
⑥	TP14770	Shoe 6	1 piece	●			
⑦	TB10191	Convex Shoe	1 piece		●	●	



*1 for Abrasive belt width 6mm

